

## How to Connect your Chromebook to your Home Wi-Fi

1. In the lower-right corner of the screen, click on your account picture (next to the time, Wi-Fi symbol, and battery icon).

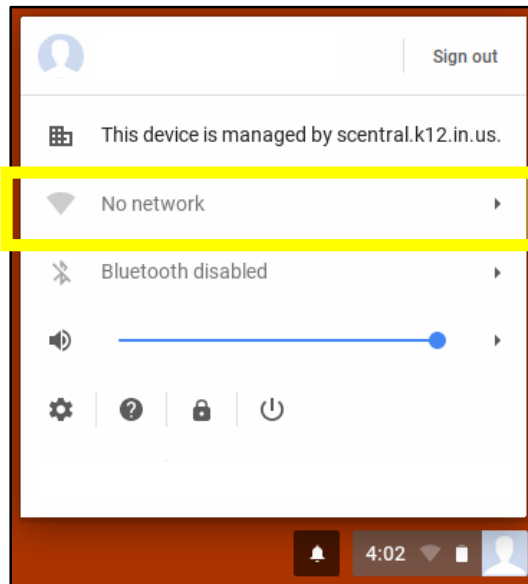

2. Click  No network from the menu options.



3. Select the name of your home Wi-Fi network from the list (the name of your Wi-Fi is unique to your home). Your Chromebook will automatically look for available networks.

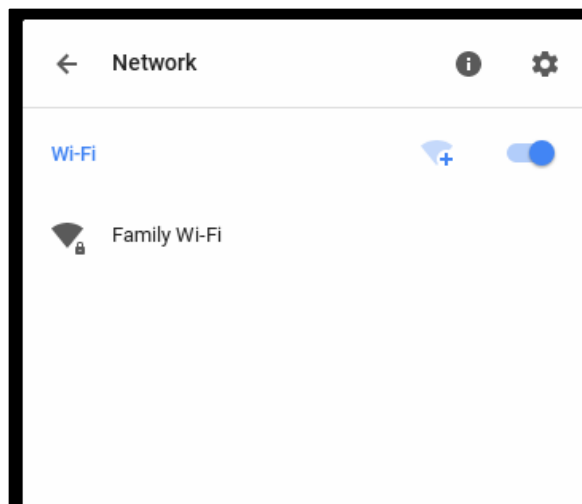

4. If your home Wi-Fi network has a password, a box will appear prompting you to type it in. Click the **Connect** button once your password has been entered.

If your home Wi-Fi doesn't have a password, the Chromebook will connect once clicked.

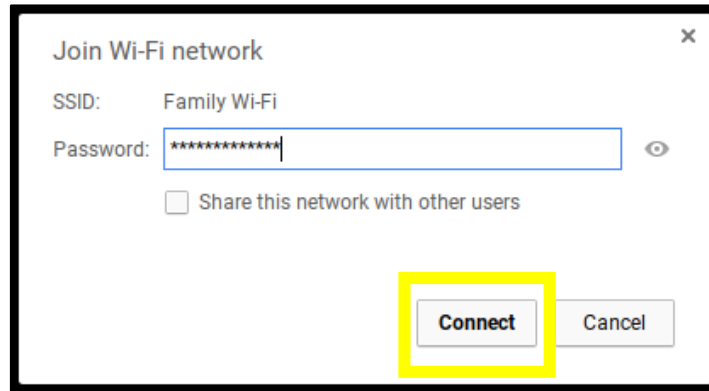

5. If the connection was successful, the home Wi-Fi name will appear in the menu and the Wi-Fi symbol in the lower-right corner will show the signal strength.

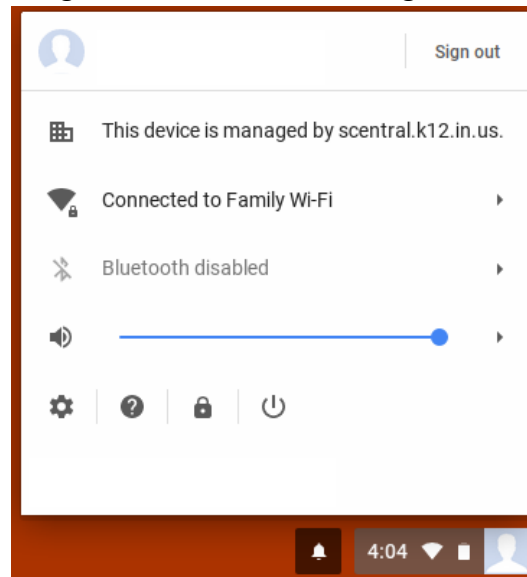

6. To access the internet on your Chromebook (at school or at home), you must sign in to the Lightspeed filter. If the login screen does not appear once you first open the Chrome browser, type ***http://lsaccess.me/login*** in the address bar.